

## INCREASED SAFETY

# EFXE Series - Stainless steel AISI 316 L



Push button stations EFXE Series, made of stainless steel AISI 316 L, are manufactured by using enclosures AQ../AR.. and SB Series.

They are designed to meet the requirements for use ON and OFF-SHORE, in petrochemical and marine applications and for any other industry where an explosive atmosphere may be present.

They can be equipped with following Ex de certified components:

- Standard and emergency push buttons,
- Rotating switches,
- Signalling lamps,
- Measurement instruments.

## TECHNICAL FEATURES

<b>Material</b>	Stainless steel AISI-316L
<b>IP rating</b>	IP65/IP66
<b>Ambient temperature range</b>	-50°C to +60°C (ATEX) -50°C to +95°C (IECEX)
<b>Approvals</b>	IMQ 08 ATEX 028X IECEX IMQ 15.0002X TR CU
<b>Marking</b>	II 2 GD Ex de IIC T(**) Gb/Ex mb IIC T(**) Gb Ex tb IIIC T(**) Db IP65/66 ** T6/T85°C, T5/T100°C, T4/T135°C
<b>Surface treatment</b>	Acid treatment
<b>Standard certificate label</b>	Made by self adhesive UV and corrosion resistant polyester, approved by certified Laboratory
<b>Accessories available upon request</b>	Electropolish treatment Side gland plates Hinges Drain/breather valve Traffolyte/Stainless steel certificate label Internal mounting plate Locking facility Passing through earth bolt

## Dimensions EFXE

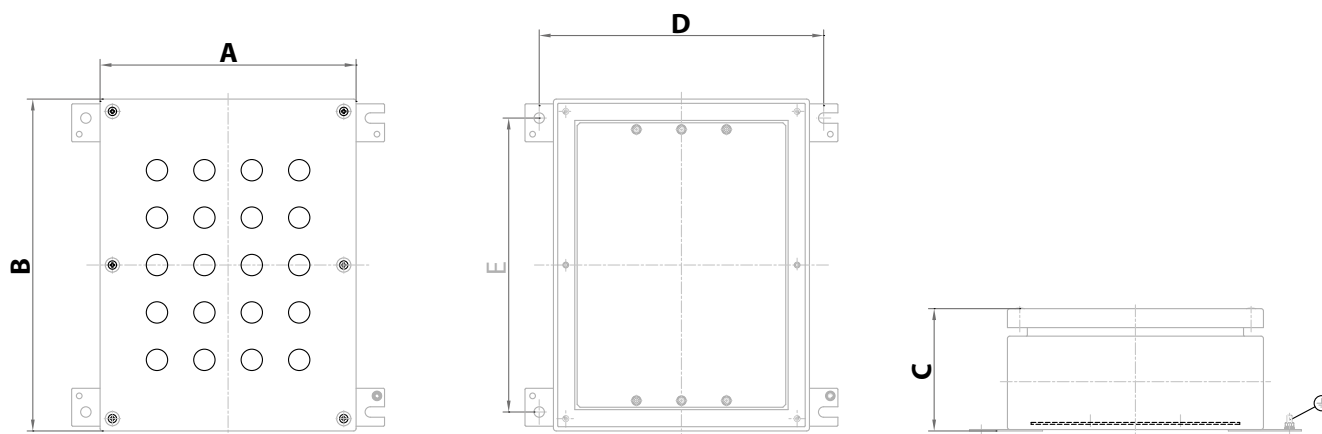

## EFXE Series - Stainless steel push button stations

TYPE	DIMENSIONS [mm]					WEIGHT [Kg]
	A	B	C	D	E	
EFXE-2727	270	270	130	300	230	4,5
EFXE-3535	350	350	160	380	310	5,6
EFXE-1320	137	200	130	170	-	4
EFXE-2027	200	270	130	230	230	7
EFXE-2735	270	350	130	300	310	9,5
EFXE-3550	350	500	160	380	460	13
EFXE-5050	500	500	160		460	14,5

\* For complete push button stations is necessary to ask to the Sales Office.

## Maximum number of entries on sides and cover

TYPE	EFXE-2727		EFXE-3535		EFXE-1320		EFXE-2027		EFXE-2735		EFXE-3550		EFXE-5050	
	A	B	A	B	A	B	A	B	A	B	A	B	A	B
M20/1/2"	12	12	24	24	6	10	10	12	12	16	24	36	36	36
M25/3/4"	10	10	14	14	4	8	8	10	10	14	14	20	20	20
M32/1"	4	4	12	12	2	3	3	4	4	6	12	18	18	18
M40/1" 1/4	4	4	5	5	2	3	3	4	4	5	5	7	7	7
M50/1" 1/2	3	3	4	4	1	2	2	3	3	4	4	6	6	6
M63/2"	3	3	3	3	1	2	2	3	3	3	3	5	5	5
M75/2" 1/2	-	-	3	3	-	-	-	-	-	-	3	4	4	2
M80/3"	-	-	2	2	-	-	-	-	-	-	4	4	4	4
COVER ENTRIES	16		25		6		12		20		40		64	